

# Parts for ATSCO GV-601 Vertical Grinder

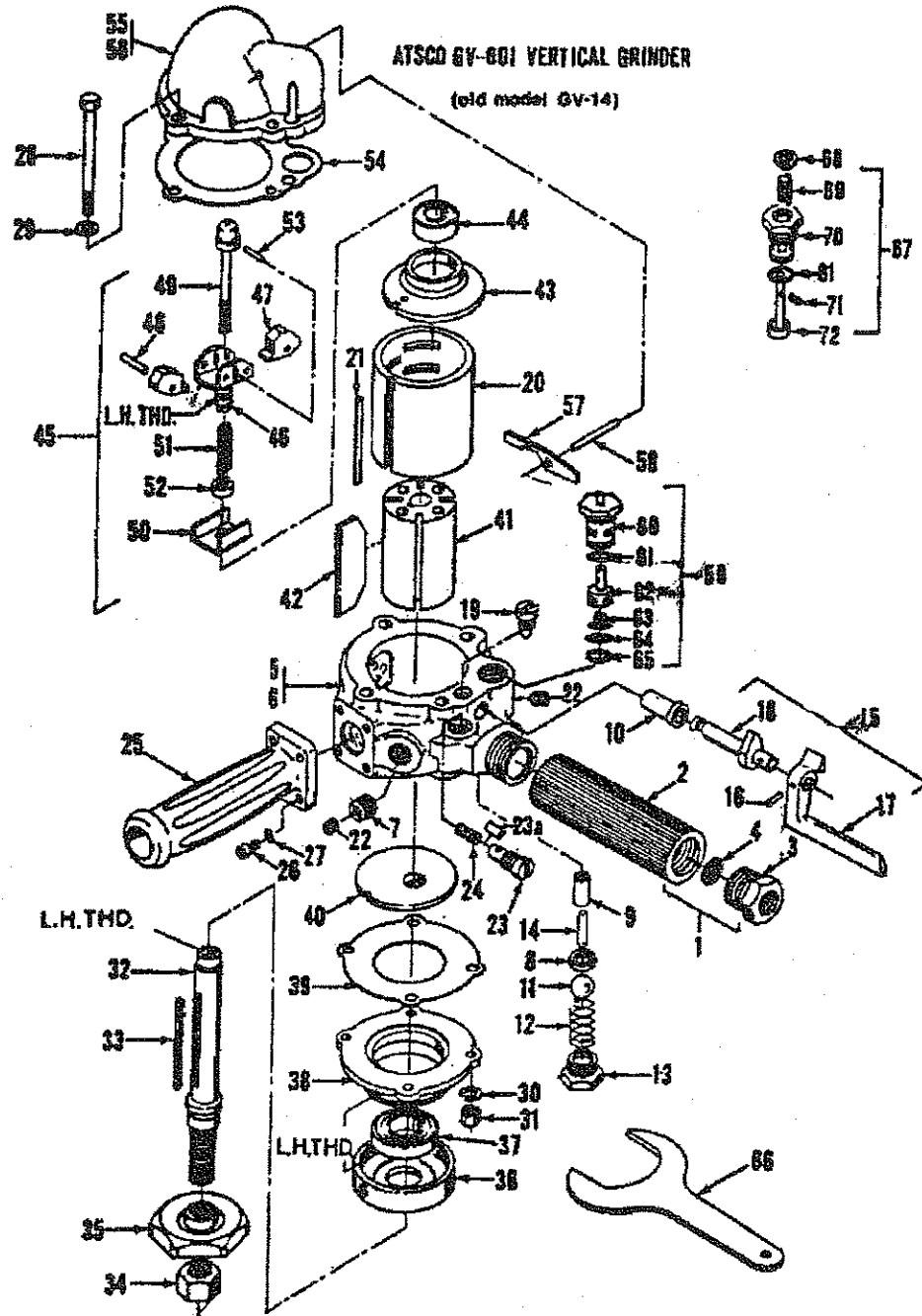

# Parts for ATSCO 601 GRINDER

ITEM NO.	ATSCO NO.	MFG NO.	DESCRIPTION
1	60A-601	695739	LIVE HANDLE COMPLETE
2	60-601	695738	LIVE HANDLE
3	45-601	700057	INLET BUSHING
4	95-206	695930	INLET SCREEN
5	100A-601	695705	MOTOR HOUSING ASSEMBLY
6	100-601	695704	MOTOR HOUSING
7	57-601	695802	OIL PLUG BUSHING
8	25C-601	695629	THROTTLE VALVE SEAT
9	27A-601	695735	LIFT PIN BUSHING
10	27-601	695734	THROTTLE CAM BUSHING
11	33-J10	695775	PLUG
12	35-601	695770	THROTTLE VALVE
13	26-601	695758	THROTTLE VALVE SPRING
14	30-601	695733	THROTTLE VALVE PLUG
15	28-601	695772	THROTTLE VALVE LIFT PIN
16	31A-401	68491	THROTTLE LEVER ASSEMBLY
17	2093-0562		THROTTLE LEVER PIN
18	31-401	695623	THROTTLE LEVER
19	82A-501		THROTTLE CAM
20	80-601	695740	RETAINING SCREW
21	90-601	695730	CYLINDER LINER
22	92-601	695761	CYLINDER LINER KEY
23	33-J10	695775	OIL PLUG
23a	57B-GV14	695765	OILER
24	57A-2F		OILER BUSHING
25	211-601	695722	OILER FELT
26	22-601	695779	DEAD HANDLE
27	21-510	416	DEAD HANDLE SCREW (4)
28	19-601S		DEAD HANDLE LOCK WASHER (4)
29	21-GV16	700948	HOUSING BOLT (4)
30	21-601	99389-06	HOUSING BOLT WASHER (4)
31	20-601	9112	HOUSING LOCK WASHER (4)
32	201-601	695787	HOUSING BOLT NUT (8)
33	215-601	695783	SPINDLE
34	210-601	695780	ROTOR KEY
35	209-601	695729	SPINDLE NUT
36	205-601	695727	WHEEL COLLAR
37	222-5	38250	FRONT BEARING CAP
38	216-601	695719	FRONT ROTOR BEARING
39	231-601	695799	FRONT HOUSING
40	202-601	695725	FRONT GASKET
41	206-601	695782	FRONT END PLATE
42	200-601	695764-01	ROTOR
43	203-601	695726	ROTOR BLADE (4)
44	222-4	695768	REAR END PLATE
45	245-601	695748	REAR ROTOR BEARING
46	245A-601	695750	GOVERNOR COMPLETE
47	245B-601	72200	GOVERNOR BODY
48	229-601	695771	GOVERNOR WEIGHT (2)
49	217-601	695745	GOVERNOR WEIGHT PIN (2)
50	245C-601	700612	GOVERNOR SPINDLE
51	220-601	695759	GOVERNOR SHIELD
52	218-601	74241	GOVERNOR SPRING
53	2093-0812		GOVERNOR ADJUSTING NUT
54	223-601	695767	GOVERNOR SPINDLE PIN
55	87A-601	695712	REAR HOUSING GASKET
56	87-601	695711	GOVERNOR HOUSING COMPLETE
57	82-601	695753	GOVERNOR HOUSING
58	92-4	695773	GOVERNOR LEVER
59	204B-601S		GOVERNOR LEVER PIN
60	204A-601S		FAIL SAFE GOV'NR VALVE ASSEMBLY
61	93-17	695605	GOVERNOR VALVE TUBE
62	204-601S		O' RING
63	221-601S		GOVERNOR VALVE
64	219-GV16		GOVERNOR VALVE SPRING
65	5000-82		RETAINING WASHER
66	269-601	718534	RETAINING RING
Not III's.	235-601	718526	WRENCH
			6" STATIONARY GUARD

OPTIONS AND ACCESSORIES			
Not III's.	36-GV14-2		MUFFLER ASSEMBLY
	34C-GV14		MUFFLER
	36D-GV14		PAD (2)
	36E-GV14		SCREEN
	36F-GV16		WASHER (4)
	48-4G		DEFLECTOR SCREW (4)
	266-GV14		GASKET
	31A-401S		THROTTLE LEVER ASSEMBLY
	36-GV14		CASE GUARD (2)
	36B-GV14		FLAT HEAD SCREW (6)
	36-601	718535	EXHAUST DEFLECTOR
	230-601	72556	SPINDLE WASHER
235-601D7	718536	7" DISC WHEEL GUARD	
235-601D9	718537	9" DISC WHEEL GUARD	
254-601	718526	DISC PAD ADAPTOR KIT	

### LUBRICATION

Any good grade of light machine oil or oils made especially for air motors is recommended for prolonging the life of the motor parts.

The live air handle contains an oil reservoir which feeds oil to the incoming compressed air through an automatic lubricator. To fill, remove Pipe Plug. A piece of white paper held against the exhaust air while the tool is running will show a slight film of oil if the lubricator is operating properly. If not, check the supply in the oil reservoir. Also examine the Felt Oiler Packing and if dirty, wash out in gasoline or replace if necessary.

Air Line Filters and Automatic Line Lubricators properly installed on your air lines will add many more working hours to your grinders by feeding the tool clean and properly lubricated air.

### BEARINGS

All ATSCO Grinders are equipped with the best bearings obtainable. They should be checked regularly for signs of wear. If wear in the bearings is indicated, they should be replaced. Bearings are a comparatively low cost item, and the replacement before failure may prevent damage to more expensive parts.

### ROTOR BLADES

The Rotor Blades are subject to wear. Replacement should be made when they show approximately 10% wear from their original size. It is suggested that a spare set of blades be kept on hand at all times. Proper lubrication will greatly prolong the life of Rotor Blades.

If you are using any quantities of this type of tool, we wish to make the following suggestion:

Because portable air tools are mechanical devices which are often subjected to severe usage and abuse, many users have found it advantageous to maintain a minimum stock of normal wearing parts so that minor repairs can be made in their own plant. Your ATSCO representative will welcome the opportunity to instruct your repair men and to help prepare a minimum list of parts.

### OPTIONAL GOVERNOR VALVE ASSEMBLY

67	204B-601	695757	GOVERNOR VALVE ASSEMBLY
68	219-601	695755	SPRING SEAT
69	221-601	695760	GOVERNOR VALVE SPRING
70	204A-601	695741	GOVERNOR VALVE TUBE
71	93-17	695605	O' RING
72	227-601	695781	GOVERNOR VALVE PIN
	204-601	695756	GOVERNOR VALVE

PARTS INDICATED AFTER AN ITEM ARE INCLUDED WITH THAT ITEM.