

Spare parts list

for

ROCK DRILL TERRIER
(BBD 12LH)

The machine is equipped with:
Rotation chuck for $\frac{3}{4}$ " x 108 mm ($4\frac{1}{4}$ ") hexagon shank
 $\frac{5}{8}$ " nipple for air

Brief instructions on the last page

*Always use Atlas Copco spare parts. They can be
ordered from the nearest Atlas Copco representative*

Atlas Copco

ATLAS COPCO AB · STOCKHOLM 1 · SWEDEN

**ROCK DRILL TERRIER
(BBD 12LH)**

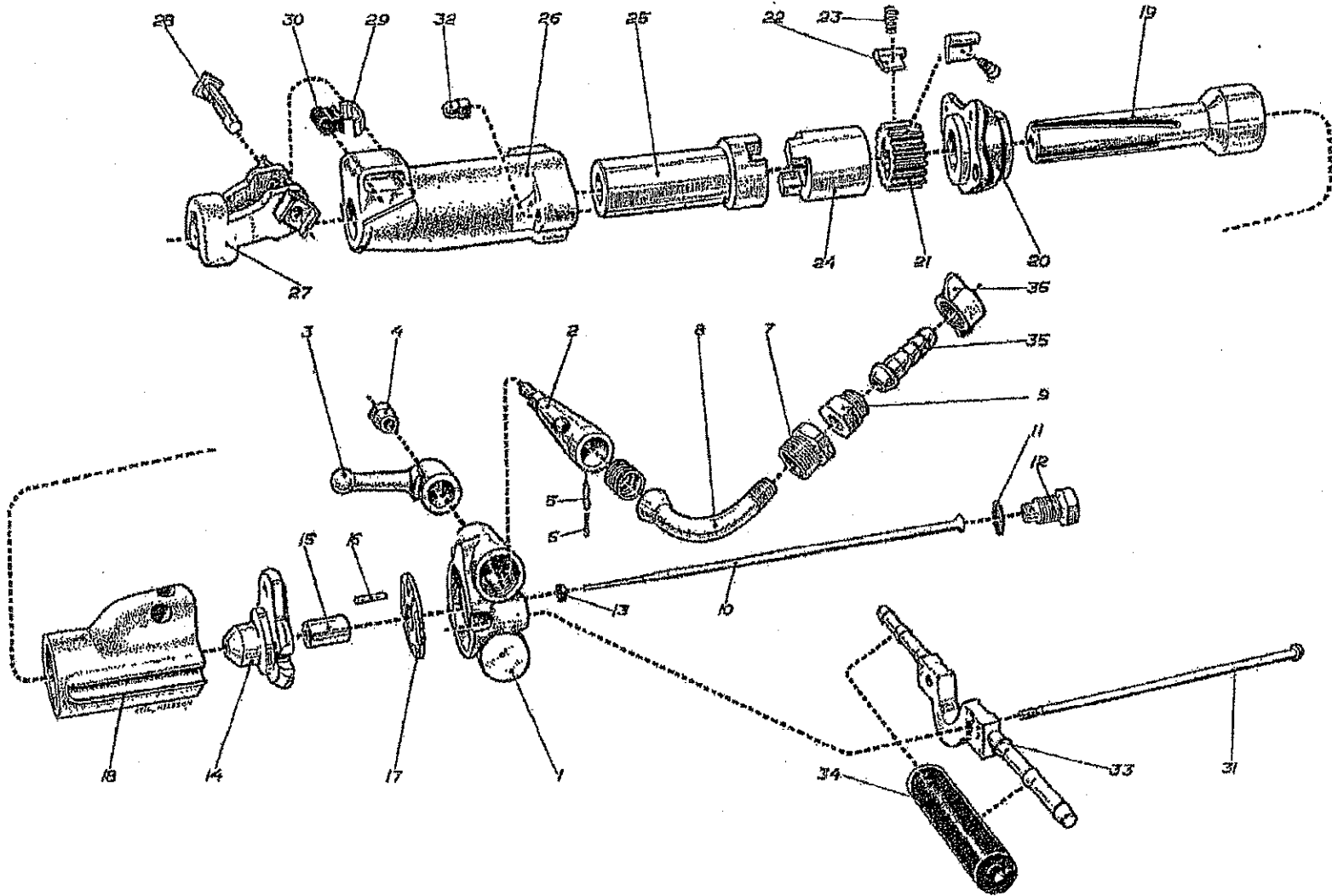

When ordering spare parts, always quote the type and serial number of the machine as well as the part number of the spare part - not the reference number

Description (and old part number)	New part number	Quantity	Ref. No.	Description (and old part number)	New part number	Quantity	Ref. No.	Description (and old part number) ¹	New part number	
ick head, compl. (BBD 353A)	3111 0039-80	1	19	Piston (BBD 313)	3111 0050	1		Parts made in oversizes		
Back head (BBD 353)	3111 0039	1	20	Interm. part (BBD 119)	3111 0017	1		2	Valve (BBD 354E1)	3111 0040-01
Valve (BBD 354)	3111 0040	1	21	Rotation ratchet (BBD 106)	3111 0019	1		19	Piston, 0.03 mm (0.0012") over-size (BBD 313E1)	3111 0050-01
Handle (BBD 293)	3111 0041	1	22	Pawl (BBD 107)	3111 0020	2		19	Piston, 0.5 mm (0.0197") over-size (BBD 313E2)	3111 0050-02
Nut (60734)	3006 0734	1	23	Spring (BBD 125)	3111 0023	2				
Pin (BBD 300)	3111 0042	1	24	Driver (BBD 108)	3111 0024	1				
Spring (9140-13)	3000 9140-01	1	25	Rotation chuck (BBD 511)	3111 0051	1				
Cap (BBD 298)	3111 0043	1		Front head, compl. (BBD 505A)	3111 0053-80	1				
Elbow (BBD 299)	3111 0044	1	26	—Front head (BBD 505)	3111 0053	1		To special order the machine can be equipped with the following parts		
Reducer (5825-2)	3000 5825-02	1	27	—Retainer (BBD 507)	3111 0054	1		Hose (A13603)	9030 0000	
r tube (BBD 303)	3111 0045	1	28	—Pin (BBD 508)	3111 0055	1		Lubricator	BLG 11	
ring (17,3x2,4A)	663 2124	1	29	—Plate (BBD 509)	3111 0056	1		<u>Parts for 7/8" x 108 mm (4 1/4") hexagon shank</u>		
ig (BBD 302)	3111 0046	1	30	—Buffer (BBD 510)	3111 0057	1		25	Rotation chuck (BBD 525)	3111 0056
cking (121)	3009 0121	1	31	Bolt (BBD 315)	3111 0061	2		27	Retainer (BBD 546)	3111 0057
over, complete (BBD 316A)	3111 0047-80	1	32	Nut (BBD 282)	3111 0062	2				
Cover (BBD 316)	3111 0047	1	33	Bolt (BBD 292)	3111 0063	1				
Bushing (BBD 312)	3111 0048	1	34	Rubber grip (BBD 314)	3111 0064	2				
Pin (7146-2)	0108 3241 00	1	35	Nipple (9659-6)	9000 0101	1				
ain valve (BBD 311)	3111 0049	1	35	Wing nut (1377)	3000 1377	1				
ylinder (BBD 121)	3111 0015	1								

ways use "New Part Number" when listing spare parts and not "Ref. No."

Parts which are included in a sub-assembly are given immediately after this spare part and preceded by a dash in the description column.