

**PARTS LIST**

**B67C**

CROWDER SUPPLY CO, INC. - 8495 ROSLYN ST. - COMMERCE CITY, CO 80022 - TOLL FREE 888-883-5144 - www.crowdersupply.com

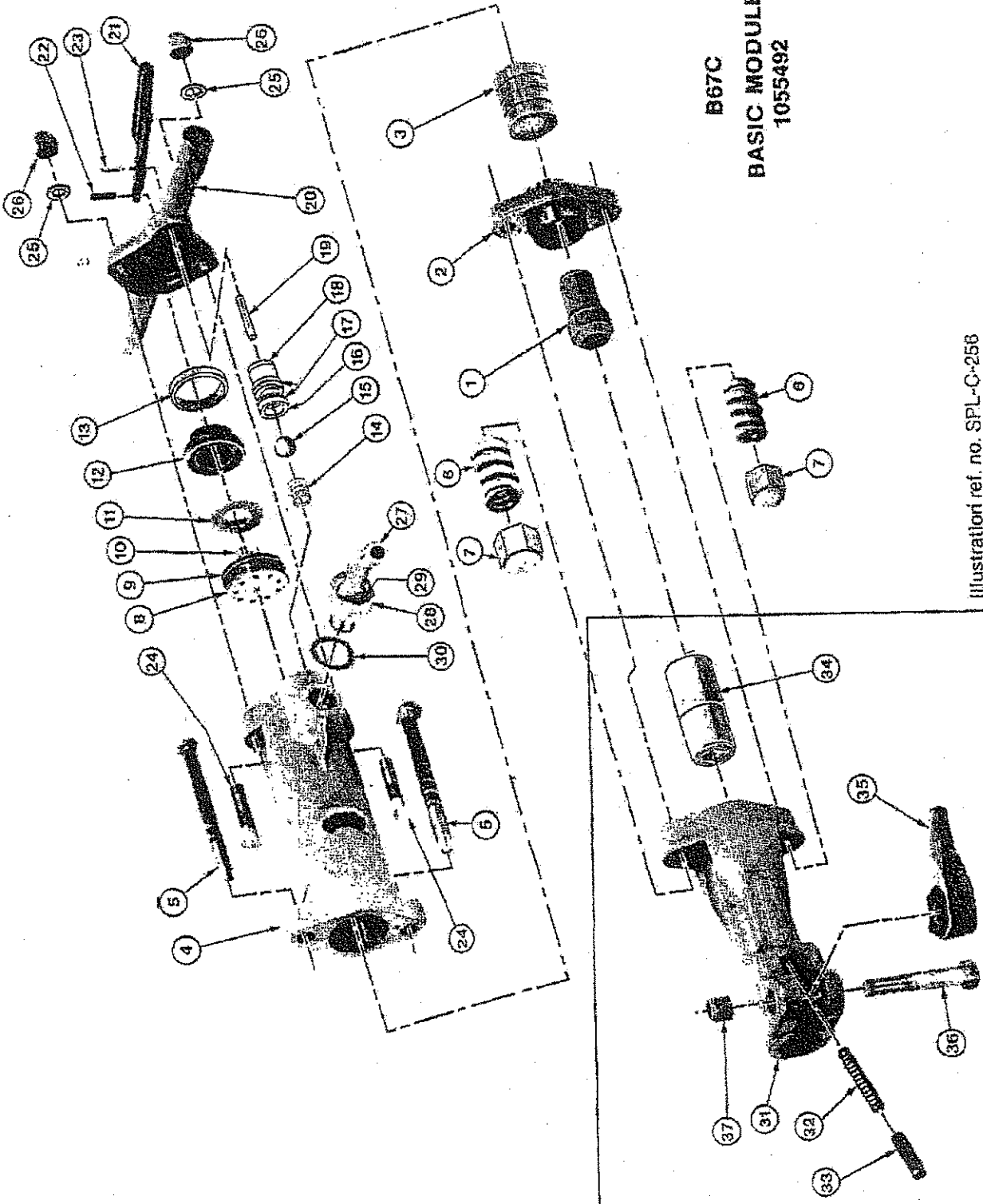

**B67C  
BASIC MODULE  
1055492**

Illustration ref. no. SPL-C-256

1058536

1056536

**PAVING BREAKER**  
BASIC MODULE 1055492

REF. NO.	PART NO.	DESCRIPTION	REF. NO.	PART NO.	DESCRIPTION
1	1055492	Basic Module - Includes parts common to all constructions, and is not complete in itself.			
2	B678A	Tappet	27	1055545	Air Connection Tube Assembly Consists of the next 4 items
3	B678L	Tappet Bushing	28	S48146G	Aircon Tube
4	B679	Hammer	29	OR21	Swivel Spud Assembly - Includes O Ring
5	1055589	Cylinder Assembly	30	S48146W	O Ring - not shown Washer
6	B67B3A	Side Rod - 2 required			
7	B873T	Spring - 2 required	31	1055493	Chuck End Module - 1-1/8" Hex Chuck Liner - includes the following:
8	B873N	Nut - 2 required	32	1B6717.	Chuck End
9	1B6715	Lower Valve Chest Assembly - includes O Ring	33	B87B36B	Spring
10	1050391	O Ring	34	B87B36E	Detent
11	B6715EA	Valve Plug	35	B727T6P	Chuck Liner, 1-1/8" Hex
12	B6716	Automatic Valve	36	B87B36D	Steel Retainer, 1-1/8" Hex
13	1B6715A	Upper Valve Chest Seal	37	1050357	Cap Screw
14	1B67715	Seal		ESF16	Lock Nut
15	1512GB	Spring		1055494	Chuck End Module - 1-1/4" Hex Chuck Liner - includes the following: same parts used as in 1055493 Chuck End Asm. above, except for the following:
16	1B87C920	Valve Ball	34	B727U6M	Chuck Liner, 1-1/4" Hex
17	1B87C93X	Valve Seat Assembly - Includes O Rings and Spacer	35	B87B36UD	Steel Retainer, 1-1/4" Hex.
18	OR21	O Ring - 2 required		1055495	Sales Literature
19	1B87C763	Spacer			
20	1B87C630	Plunger			
21	B672DX	Backhead Assembly - Consists of the next 4 items			
22	B672D	Backhead			
23	B3712A	Throttle Handle			
24	1050341	Spiral Roll Pin			
25	ERP9	Roll Pin			
26	B874	Side Rod - 2 required			
	WS36	Lockwasher - 2 required			
	S483N	Nut - 2 required			

B67C

PAVING BREAKER