

**KENT
AIR TOOL CO.**
711 Lake St. - KENT, OHIO 44240

GARDNER-DENVER MODELS PR123 AND PR123J DRIFTER

REPLACEMENT
Katco
SERVICE PARTS

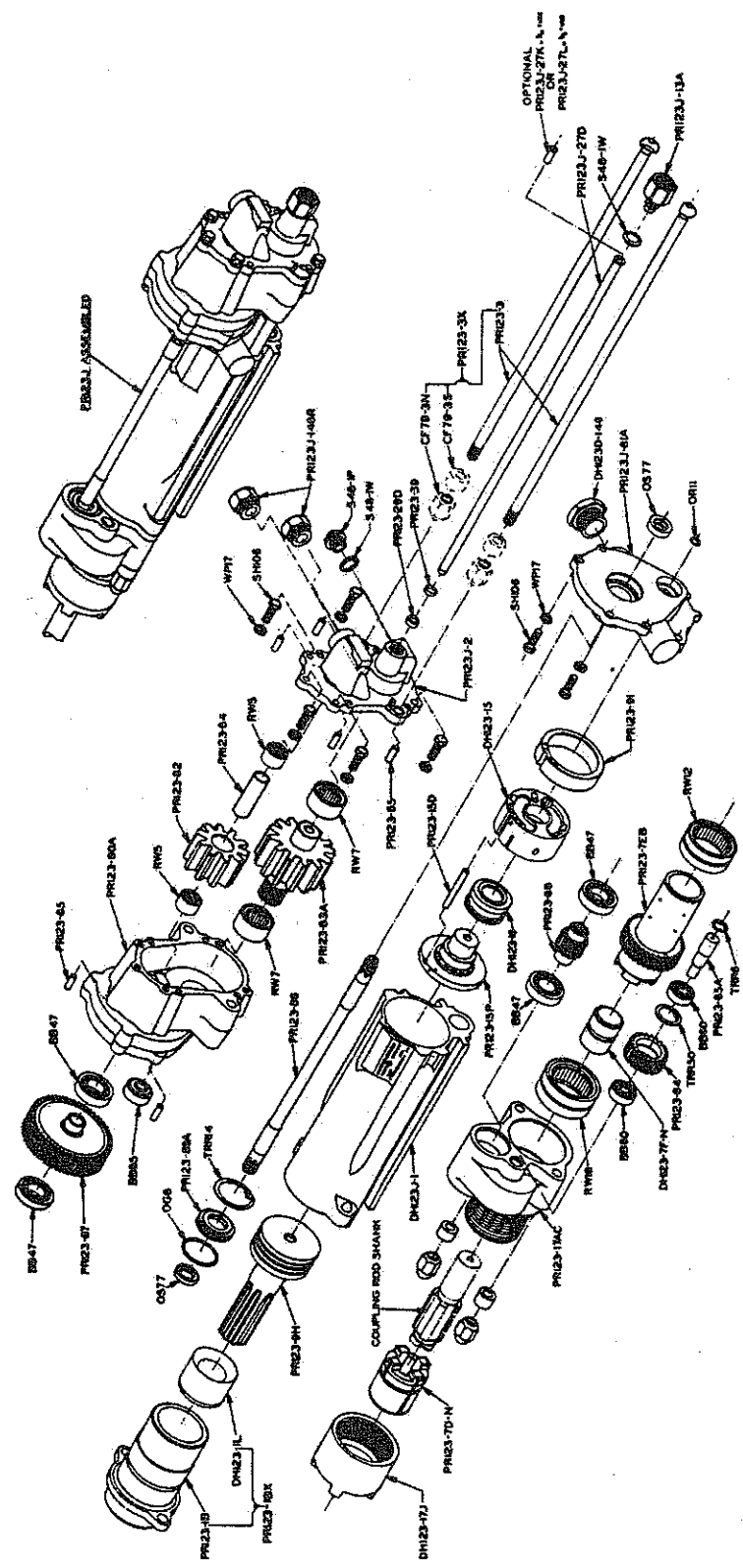

**KENT
AIR TOOL CO.**
711 Lake St. - KENT, OHIO 44240

GARDNER-DENVER MODELS PR123 AND PR123J DRIFTER

REPLACEMENT
(Katco)
SERVICE PARTS

PART NO.	REF. NO.	NAME OF PART	PART NO.	REF. NO.	NAME OF PART
DH123-1L	1570	Cylinder Liner	BB47	6305	Ball Bearing (4)
PR123-9H	1645	Hammer	PR123-87	6306	Drive Gear (Large)
PR123-3	5866	Side Rode Bare	PR123-BB85	6307	Ball Bearing (Front Flange)
PR123-85	5852	Rotor Dowel Pin	RW5	6308	Roller Bearing
PR123-84	6310	Rotor Shaft			
PP1A	5856	Detent Plug	PR123-29D	6328	Gasket
PR123-7DN	5872	Chuck (Splined)	PR123-39D	6329	Washer
DH123-7F-N	5865	Driver Bushing (1 3/4" Rd.)	RW7	6315	Roller Bearing
OR11	6050	"O" Ring	OS77	6317	Oil Seal
7-2A	5968	Detent Plunger	OG8	6318	"O" Ring
7-2ES	5969	Detent Spring	PR123-89A	6319	Seal Retainer Incl. 6317 & 6318
NJ5	5862	Nut	TRR14	6320	Retainer Ring
PR123J-86	5873	Drive Shaft	PR123-15P	5869	Plug
PR123J-27D	5851	Air Tube 9/16"	DH123-15	6322	Valve Chest
PR123-27J	5847	Air Tube 9/16" Necked 1/2" x 3 1/4"	DH123-16	6323	Valve
PR123-27JA	5847	Air Tube 9/16" Necked 1/2" x 3/4"	PR123-88	6330	Drive Gear (Small)
PR123-27A	5821	9/16 Tube Necked 7/16 x 6	PR123-91	5871	Spacer
PR123-27P	5820	9/16 Tube Necked 1/2 Plastic	1036774	6342	4 Jaw Chuck Driver
PR123-27EA	5819	9/16 Tube Necked 7/16 x 2 3/4	PR123-17R Old No.	6333	Chuck Driver Bearing, Rear
PR123-27R	5688	Tube 30%	1039706 New No.	6333	Chuck Driver Bearing, Rear
S48-1W	483	Gland Gasket	1029189	6334	Chuck Nut
S48-1P	482	Air or Water Connection Plug	DH123-17J	5858	Cap End 1 1/4" Steel
S48-1W	483	Plug Washer	PR123-17F	6336	Chuck Driver Bearing, Front
D93-13T	1565	Connection Tube Includes OR10	BB60	6337	Ball Bearing
OR10	1567	Tube "O" Ring	PR123-64	6338	Idler Gear (Incl. TRR50)
D93-13D	1568	Connection Cut	TRR50	6339	Retaining
D93-13E	1564	Nut Washer	PR123-65A	6341	Idler Gear Shaft
D93-13R	1563	Retaining Ring	TRR6	6340	Retaining Ring
107-13C	1587	Connection Spud	PR123-27A	5821	9/16 Tube Necked 7/16x6
CF79-3S	191	Side Rod Spacer	PR123-27P	5820	9/16 Tube Necked 1/2 RG
CF79-3N	189	Side Rod Nut	PR123-1B		
S48-147	1471	Connection Tube	PR123-23DP	5885	Blow Tube, Plastic
S48-146	5864	Connection Nut Includes OR21	6.MC10-13Z	5050*	Air & Water Swivel Connection
OR21	1123	Nut "O" Ring	1028636	5053	Adaptor (For Bolt on Cap)
CL5-324	1827	Housing "O" Ring	1028292	5058	Chuck End Cap-Bolt on Type 40mm (1 1/4 to 1 1/2)
107-13A	1588	Connection Screen			
107-13BA	1589	Connection Gasket			
7-60	827	Water Valve Assembly			
DH99-7D-N	6327	Chuck (4 Jaw for 1 3/4" Rd. With 1 3/4" Shank)			
17L-7C-R	1518	Driving Bushing 1 1/2" Rd.			