

# PR55 VALVELESS DRILL CONSTRUCTION A - UNDERGROUND

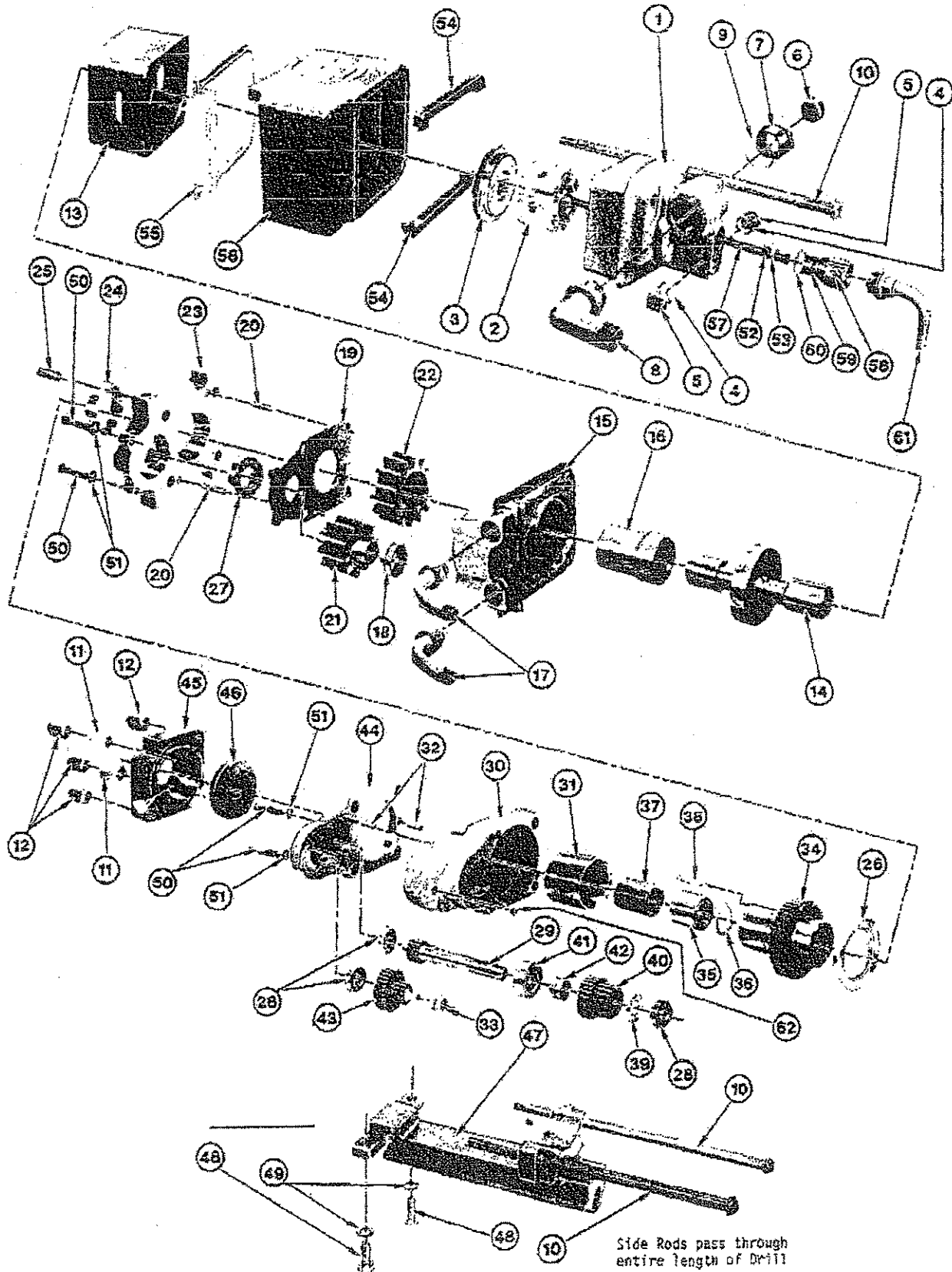

# PR55 VALVELESS DRILL CONSTRUCTION A - UNDERGROUND

- Underground Drill
- Muffled
- Stellite Ways
- 9/16" Dia. Stainless Steel Tube
- Wet Construction
- 1-3/4" Rd. x 3-13/16" 4 - Spline Shank

REF. NO.	PART NUMBER	DESCRIPTION	REF. NO.	PART NUMBER	DESCRIPTION
1	IPR552A	Backhead Assembly - Includes Distributor Bushing	39	IPR55618	Wear Plate
2	IPR55205A	Distributor Bushing	40	IPR55442A	Idler Gear
3	IPR55599A	Plate	41	8868	Ball Bearing
4	S481W	Washer - 2 req'd.	42	RW9	Roller Bearing
5	S481P	Filler Plug - 2 req'd.	43	IPR55440	Gear
6	PP7A	Pipe Plug	44	IPR55282	Chuck End Plate
7	DH1230146	Bushing	45	IPR55277	Chuck End Cap
8	DH123147X	Air Connection Tube See page 7 for component parts.	46	IPR55496	Insert Set - For Shanks of 1 3/8" diameter or smaller spline
9	CF99146W	Washer	47	IPR55947B	Way
10	IPR553	Side Rod - 4 req'd.	48	1048533	Cap Screw - 2 req'd.
11	IPR55763	Spacer - 2 req'd.	49	1047864	Washer - 2 req'd.
12	CF793N	Nut - 4 req'd.	50	1050304	Cap Screw - 4 req'd.
13	IPR551	Cylinder	51	WP17	Washer - 4 req'd.
14	IPR559	Hammer	52	PR133J290	Tube Gasket
15	IPR5580	Rotor Housing Assembly Includes Bushing	53	IPR23945A	Tube Washer
16	IPR55223B	Bushing	54	IPR55715B	Seal - 2 req'd.
17	S481476X	Air Connection Tube - 2 req'd. See page 7 for component parts.	55	IPR55715A	Seal
18	1049813	Roller Bearing	56	IPR55543T	Muffler
19	IPR5581	Rotation Housing Plate Assembly Includes Pins	57	IPR55127A	Water Tube
20	1039515	Pins - 2 req'd.	58	IPR55786	Spud Assembly Includes O Ring and Washer
21	IPR55687	Drive Rotor	59	OR18	O Ring
22	IPR55686A	Rotor	60	DB340	Washer
23	IPR55602B	Bearing Plate Assembly Includes Bearing, Pins, and Plate	61	6MC1013Z	Air Connection Tube. See page 7 for component parts.
24	IPR55163	Bearing			
25	1039515	Pins - 2 req'd.			
26	IPR55599	Plate			
27	BB138	Ball Bearing			
28	BBS	Ball Bearing - 3 req'd.			
29	IPR5586	Drive Shaft			
30	IPR5517A	Chuck End Assembly Includes Bushing, Pins, and Pipe Plug			
31	IPR55223A	Bushing			
32	1039515	Pins - 2 req'd.			
33	PP2A	Pipe Plug			
34	1049812	Roller Bearing			
35	IPR55275	Chuck Driver Assembly - Includes Liner, Retainer Ring, Chuck and Pin			
36	IPV23278A	Chuck Liner			
37	IPR55676	Retainer Ring			
38	IPR557	Chuck			
	IPR55579	Pin			