



MODEL 4130, 4131, 4132, 4133 BACKFILL TAMPER



38/40 LB. CLASS

- 4130 - ALUMINUM BUTT (FOUNDRY)
- 4131 - MALLEABLE " (CONSTRUCTION)
- 4132 - ALUMINUM " (POLE TAMPER)
- 4133 - STEEL 3" " (POLE OR FOUNDRY)

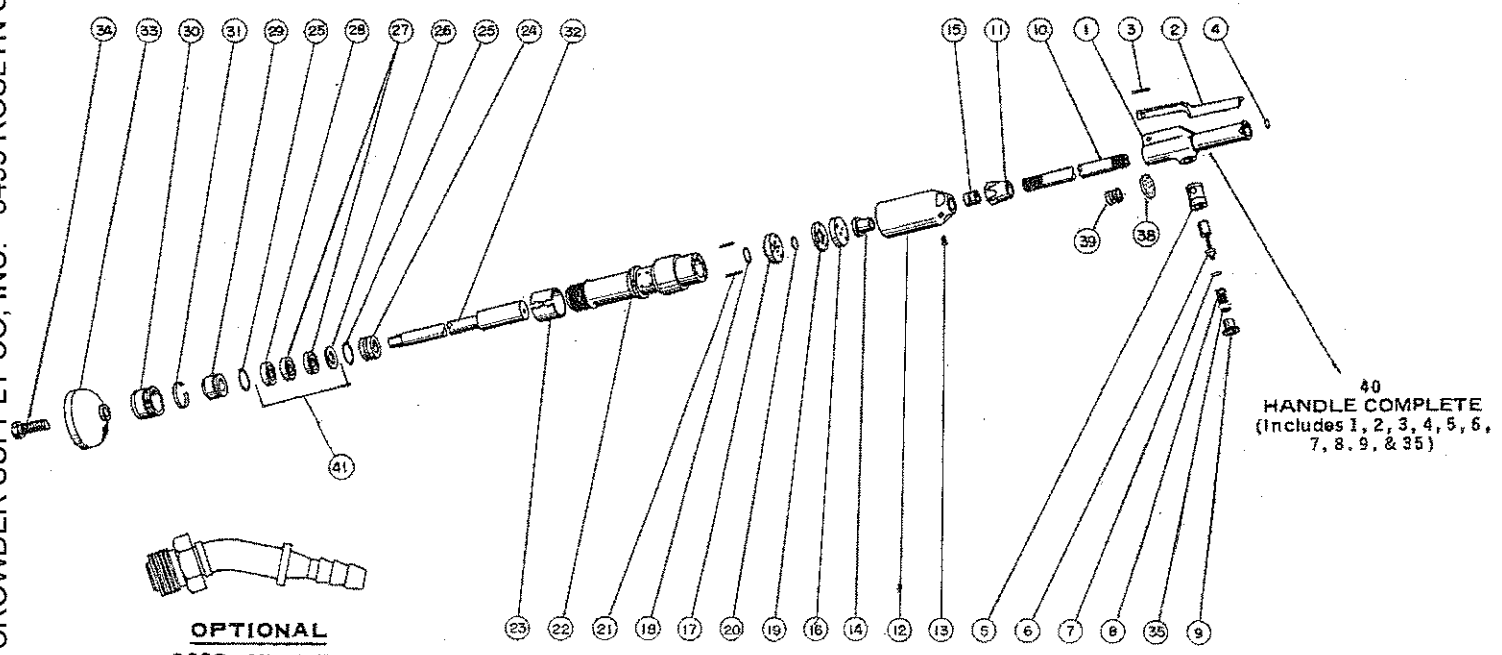
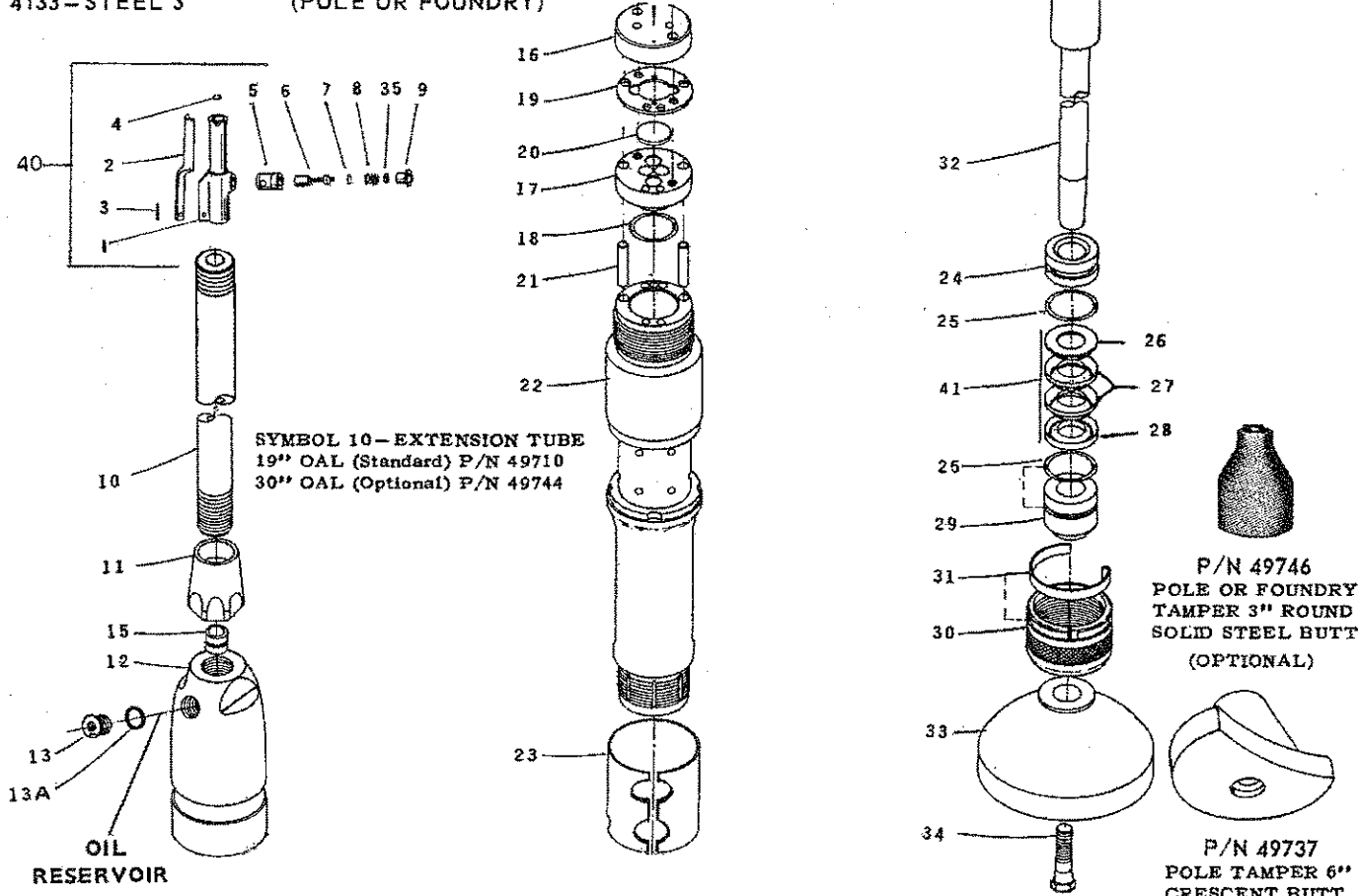

OPTIONAL
9098 SWIVEL
ASSEMBLY 1/2" NPT

CROWDER SUPPLY CO., INC. - 8495 ROSLYN ST. - COMMERCE CITY, CO 80022 - TOLL FREE 888-883-5144 - www.crowdersupply.com

HARPER TAMPER - INTERCHANGE PARTS LIST

SYM. NO.	NAME OF PART DESCRIPTION	AMT REQ	HARPER PART NO.	A.P.T. PART NO.	KENT PART NO.	THOR PART NO.
1	Handle (Bare)	1	49701	N/A	N/A	N/A
2	Handle Throttle Lever	1	49702	N/A	N/A	N/A
3	Handle Lever Pin	1	49703	N/A	N/A	N/A
4	Handle Lever Ring	1	49704	N/A	N/A	N/A
5	Throttle Valve Bushing	1	49705	N/A	N/A	N/A
6	Throttle Valve	1	49706	N/A	N/A	N/A
7	Throttle Valve O-Ring	1	49707	N/A	N/A	N/A
8	Throttle Valve Spring	1	49708	N/A	N/A	N/A
9	Throttle Valve Plug (Cap)	1	49709	N/A	N/A	N/A
10	Connecting Pipe 19" OAL Std.	1	49710	238	4257	94541
	Connecting Pipe 30" (Optional)		49744	N/A	N/A	N/A
11	Connecting Pipe Lock Nut	1	49711	251	4258	94542
12	Cylinder Cap (Inc. 49714 & 15)	1	49764	N/A	4271	94545
13	Oil Res. Plug	1	49755	3113	4282	80939
13A	Oil Plug O-Ring Seal	1	67108	3114	N/A	80951
14	Cylinder Cap Bushing	1	49714	N/A	N/A	N/A
15	Valve Housing Bushing	1	49715	3111	4259	94543
16	Upper Valve Block	1	49716	253	4268	95488
17	Lower Valve Block	1	49717	N/A	4260	94546
18	Valve O-Ring	1	49718	2224	4262	94550
19	Center Valve Plate	1	49719	255	4261	94547
20	Automatic Valve	1	49720	254	4500	1018
21	Valve Block Pin	2	49721	257	4280	75439
22	Cylinder	1	49722	N/A	4272	94552
23	Exhaust Deflector	1	49723	3178	4263	94553
24	Upper Guide Bushing	1	49724	3397	4265	94555
25	Guide Bushing O-Ring	2	49725	1746	4288	91492
26*	Packing - Upper Section	1	49743			
27*	Packing - Middle Section	2	49743			
28*	Packing - Lower Section	1	49743			
29	Lower Guide Bushing	1	49729	2173	4286	91489
30	Packing Nut	1	49730	3504	4264	94554
31	Lock Ring	1	49731	2078	4279	75431
32	Piston	1	49732	3005	4266	94557
33	Butt 6" Round Aluminum Hollow		49745	1973	4276	26067
	Butt 6" " Malleable "	1	49736	939	4269	73206
	Butt 6" Crescent Alum. Solid		49737	2647	1642	22303
	Butt 6" Round " "		49745			
	Butt 3" " Steel "		49746	3566		
	Butt 6" Crescent " "		49747	2655		
34	Butt Locking Screw	1	49734	3003	4267	94558
35	Throttle Valve Plug O-Ring	1	49735	1786	N/A	N/A
38	Air Screen	1	49738	240	N/A	N/A
39	Screen Retaining Spring	1	49739	241	N/A	N/A
40**	Throttle Handle Complete		49740**	1790**	2302**	94540**
41	Packing Set Comp. Teflon (Std)		49743	2997	4287	91491
	Packing Set Garlock (Optional)		49743			

* Symbols 26, 27 & 28 (4 pcs.), Part Nos. 49726, 49727 & 49728 make a complete Packing Set, which can be ordered as Part No. 49741 (Sym. 41).

** Symbol 40, Part No. 49740, Throttle Handle Complete, includes (Sym. No. 1, 2, 3, 4, 5, 6, 7, 8, 9, 35), will, as a complete unit, replace A.P.T. P/N 1790, Kent P/N 2302, and/or Thor P/N 94540, and can also be used on many Ingersoll-Rand, Chicago Pneumatic, etc. Tamper. The HATCO Handle Assembly will fit any Tamper which uses a standard 3/4" NPT Male Extension Pipe.

WHEN ORDERING PARTS, PLEASE SPECIFY: MAKE, MODEL, PART NUMBER AND PART DESCRIPTION.