



# HARPER CHIPPING HAMMERS



MODELS 4171, 4172, 4173, 4174 - .680 ROUND BORE  
 MODELS 4181, 4182, 4183, 4184 - .580 HEXAGON "

## NAVY STANDARD CHISEL SHANKS

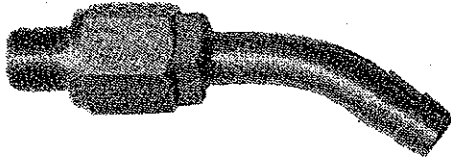
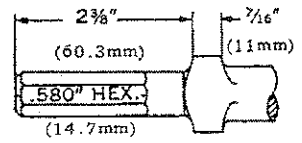
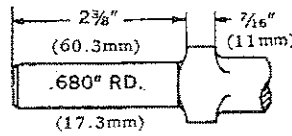

9090 - SWH, SWIVEL WHIP HOSE  
 AVAILABLE (SIMILAR TO 9100 - SWH)

3/8" NPT x 1/2" HOSE BARB

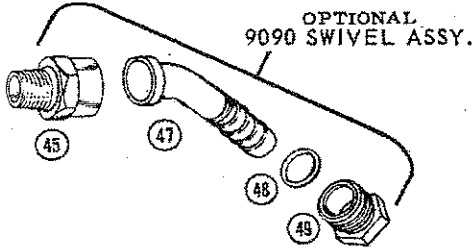

DO NOT REMOVE AIR INLET BUSHING (P/N 60510, SYM. 10) TO INSTALL 9090 SWIVEL ASSY. NPT 3/8" MALE ADAPTER SCREWS INTO BUSHING.

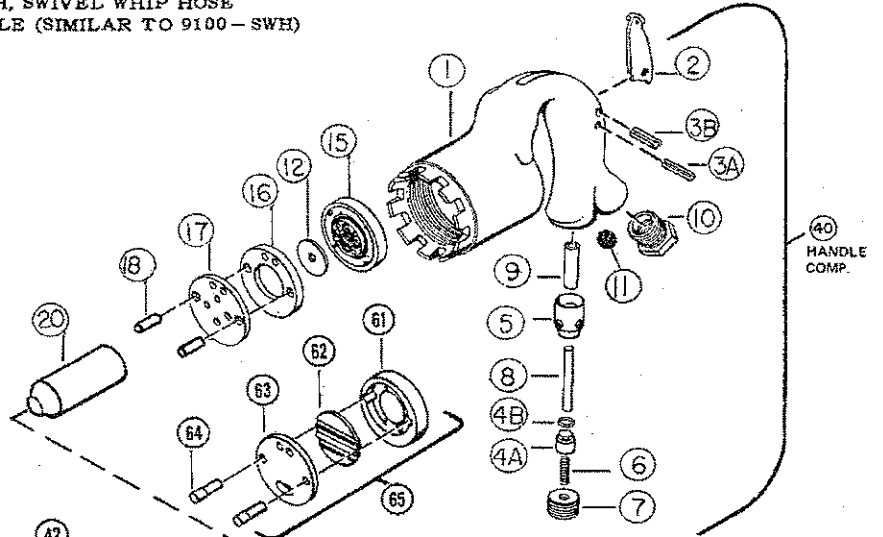

HANDLE COMPLETE INCLUDES:  
 SYM. NOS. 1, 2, 3A, 3B, 4A, 4B, 5, 6, 7, 8, 9, 10 & 11.

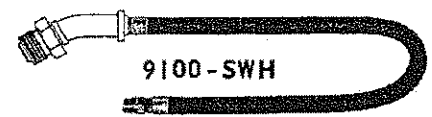
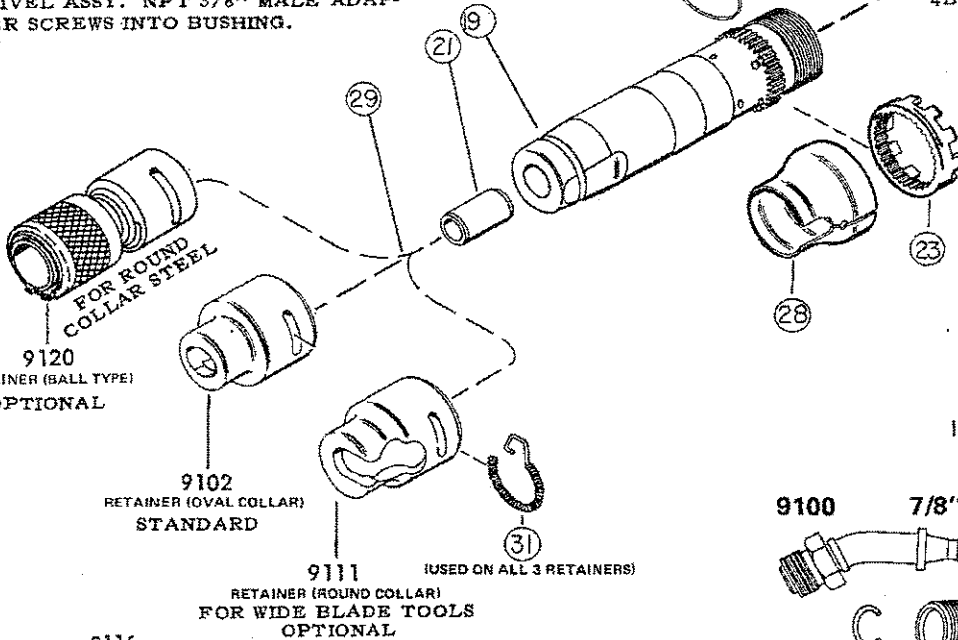

9100 - SWH  
 SWIVEL WHIP HOSE ASSY.  
 10' OVER-ALL  
 1/2" I.D. w/1/2" NPT M FITTING

OPTIONAL

9100 7/8"-24 thd. nut Swivel Assembly 1/2" Hose Barb, Hose End.

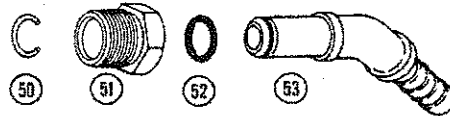

9096 7/8"-24 thd. nut Swivel Assembly 3/8" N.P.T. Male, Hose End.

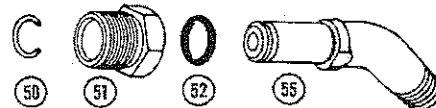

CAUTION: INSPECT LOCKCOIL SPRING (Sym. 31) FREQUENTLY FOR EXCESSIVE WEAR AND REPLACE IF NECESSARY. FAILURE TO OBSERVE THIS PRACTICE MAY RESULT IN SERIOUS INJURY TO THE OPERATOR.

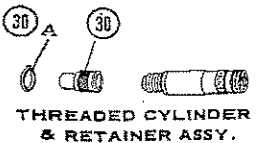

HATCO CAN SUPPLY THREADED LUG TYPE OVAL COLLAR (9104) OR ROUND COLLAR (9117) RETAINERS AND CLIP BAND SPRING (9103) ONLY FOR CHIPPING HAMMERS WITH THREADED CYLINDERS.

REMOVE AIR INLET BUSHING (P/N 60510, SYM. 10) TO INSTALL 9100 SWIVEL ASSEMBLY.

# HARPER CHIPPING HAMMER - INTERCHANGE PARTS LIST

SYM NO.	NAME OF PART DESCRIPTION	AMT REQ	HARPER PART NO.	A.P.T. PART NO.	KENT PART NO.	I-R PART NO.	C.P.T. PART NO.
1	Handle (Bare)	1	60501	2476			
2	Throttle Lever	1	60502	802	5018	C-134	TP-124858
3A	Lever Pin - Long	1	60503	306	5006	C-15	TP-124857
3B	Lever Pin - Short	1	60513	651			TP-124864
4A	*Throttle Valve .510" Dia.	1	60504	2477	5032	HH-602	TP-124851
4B	*Throttle Valve O-Ring	1	60514	1786		283	TP-124853
5	*Throttle Valve Bushing	1	60505	1783		HO2-65S	TP-124852
6	Throttle Valve Spring	1	60506	1918	5020	AR-274	TP-124850
7	Throttle Valve Pressure Plug	1	60507	1945	5025	HH-266	TP-124849
8	Throttle Valve Push Pin	1	60508	1947	5019	HH-604	TP-124854
9	Push Pin Bronze Bushing	1	60509	781	5013	HH-603	TP-124855
10	Air Inlet Bushing	1	60510	759	5026	H-282	TP-124856
11	Air Screen	1	60511	286	5014	H-82	
12	Automatic Valve	1	60512	698	5000	HH-2A	TP-124861
15	Valve Seat - Rear	1	60515	884	5002	HH-4	TP-124860
16	Valve Guide - Middle	1	60516	1784	5005	HH-8A	TP-124862
17	Valve Seat - Front	1	60517	883	5001	HH-3	TP-124863
18	Valve Dowel Pin	2	60518	743	5008	HH-32	TP-124865
19	Cylinder 1" Slip On Type	1	60519	1421			
	Cylinder 2" Slip On Type		60524	1422	5041	2AH-106	TP-124867
	Cylinder 3" Slip On Type		60526	1423	5042	3AH-106	TP-124873
	Cylinder 4" Slip On Type		60527	1424	5043	4AH-106	TP-124875
20	Piston 1" Stroke	1	60520	1533	5027	HH1-5	
	Piston 2" Stroke		60532	1533	5003	HH1-5	TP-124866
	Piston 3" Stroke		60533	1534	5003	HH2A-5	TP-124872
	Piston 4" Stroke		60534	703	5028	HH4-5	TP-124874
21	Bushing .680" Round	1	60521	272	5007	BO1-19B	TP-124855
	Bushing .580" Hex.		60522	273	5004	BO1-7B	
23	Locking Ring	1	60523	1231	5024	HH-196	TP-124868
28	Exhaust Deflector	1	60528	1785	5040	BHH-85	TP-124869
29	Retainer, Oval Collar (Std.)	1	9102	1940	5044	1-1190	TP-124870
	Retainer, Round " (Optional)		9111	2648			
	Retainer, " " "		9116				
	Retainer, Ball Type "		9120	5549			
30	Retainer, Screw-on, Oval Col.		9104				
	Retainer, " " , Round "		9117				
30A	Clip Band Spring (9104 & 9117)		9103	3485			
31	Spring, Lockcoil (9102, 11, 16, 20)	1	9101	1941	5045	1-1194	TP-124871
40	Handle Assy. Complete		60540	1735	N/A	HH-1A	TP-124859
41							
42	Cylinder O-Ring Retainer	1	60542				
43							
44							
45	Swivel Adapter 3/8"NPT(9090)		60545				
46	Swivel Adapter 1/2"NPT(9090)		60546				
47	Swivel Stem 1/2"Hose Barb "		60547				
48	Swivel Nut O-Ring. "		60548				
49	Swivel Nut "		60549				
50	Snap Ring Retainer (9100)		60550				
51	Swivel Nut "		60551				
52	Swivel Nut O-Ring "		60552				
53	Swivel Stem 1/2"Hose Barb "		60553				
54							
55	Swivel Stem 3/8"NPT Male		60555				
61	Valve Chest, Rear, Rocker Type		60561	2221			
62	Valve, Automatic "		60562	699			
63	Valve Cover, Front "		60563	1233			
64	Valve Dowel Pin "		60564	744			
65	Valve Assy. Complete "		60565				

\* Note: Throttle Valve diameter is .510". In rebuilding a tool or replacing throttle valve, it is advisable to replace both the valve bushing and throttle valve with O-Ring to insure perfect seal.

### STEEL COLLAR AND SHANK TYPES FOR CHIPPING HAMMERS

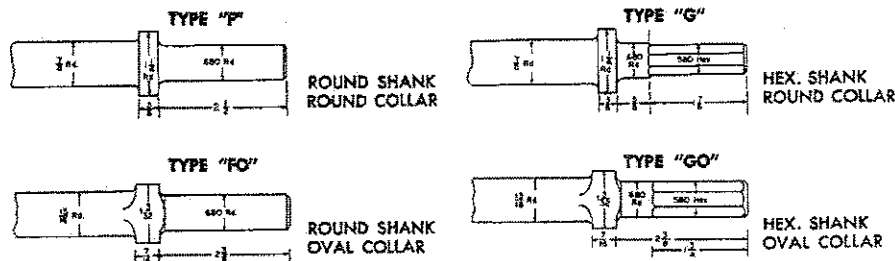

WHEN ORDERING PARTS, PLEASE SPECIFY: MAKE, MODEL, PART NUMBER AND PART DESCRIPTION.