

# INGERSOLL RAND 95 AND 93 DIGGER

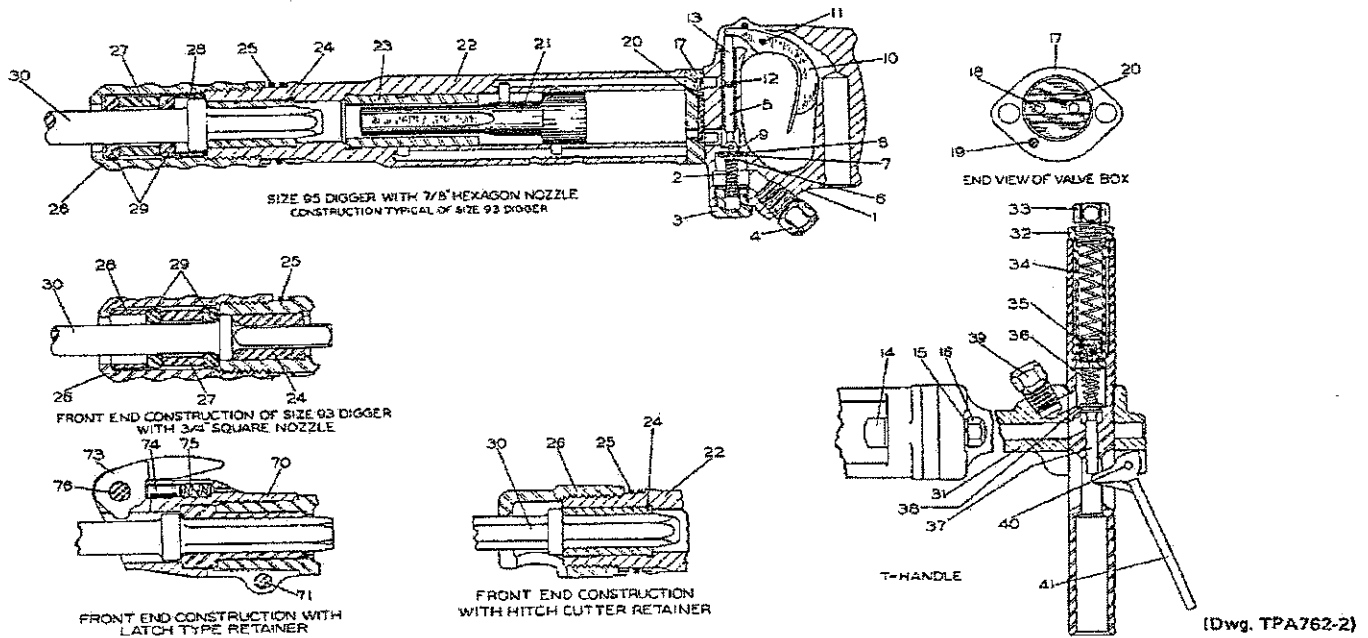

PART NUMBER FOR ORDERING

PART NUMBER FOR ORDERING

1	Inside Trigger Handle Assembly . . . . .	7500-92	• 27	Buffer . . . . .	93H-50
2	Throttle Valve Spring . . . . .	H80-11	• 28	Buffer Spacer . . . . .	93H-31
3	Throttle Valve Cap . . . . .	7500-109	• 29	Buffer Washer (2) for accessories with hex shanks . . . . .	93H-331
4	Inlet Bushing (1/2" pipe to 3/8" pipe) . . . . .	H80-82A		for accessories with square shanks . . . . .	93H-431
• 5	Throttle Valve . . . . .	8000-50	30	Accessory (Ingersoll-Rand offers a complete line of Chisels, Flat Picks, Spades, etc.) Inquire at nearest Office for types and prices.)	
6	Throttle Valve Face Cap Nut . . . . .	73H-158		T-Handle Assembly . . . . .	93H-A35
7	Throttle Valve Face Cap . . . . .	8000-157	31	Handle Assembly . . . . .	157H-A36
8	Throttle Valve Face . . . . .	8000-159A		Oiler Assembly . . . . .	157H-A72
9	Throttle Valve Face Lock Washer . . . . .	H54U-352	32	Oiler Body . . . . .	157H-72
10	Throttle Lever . . . . .	97MP-18	33	Oiler Plug . . . . .	157H-73
11	Throttle Lever Pin . . . . .	13SR-265	34	Oiler Spring . . . . .	157H-74
12	Throttle Valve Bushing . . . . .	7500-65	35	Oiler Felt . . . . .	157H-71
13	Throttle Valve Plunger . . . . .	7500-64	36	Throttle Valve Spring . . . . .	TAA-418
14	Handle Bolt (2) . . . . .	A-9	• 37	Throttle Valve Assembly . . . . .	159H-53
15	Handle Bolt Lock Washer (2) . . . . .	H80-67	38	Throttle Valve Face . . . . .	PS3-51
16	Handle Bolt Nut (2) . . . . .	H3R-8	39	Inlet Bushing (1/2" to 3/8" pipe) . . . . .	H80-82A
17	Valve Box . . . . .		40	Throttle Lever Pin . . . . .	13SR-264
	for Series 93 . . . . .	73H-41	• 41	Throttle Lever . . . . .	158H-66
	for Series 95 . . . . .	75H-41			
18	Valve Dowel (2) . . . . .	73H-45			
19	Valve Box Dowel . . . . .	73H-21			
20	Valve . . . . .				
	for Series 93 . . . . .	33SR40			
	for Series 95 . . . . .	33SR-40			
• 21	Piston . . . . .		†	Fronthead Assembly for accessories with 1-3/8", 1-1/2" or 1-5/8" diameter collar (35, 38 or 41 mm) for tools with 7/8" hex x 3-1/4" Nozzle . . . . .	95L-A240
	for Series 93 . . . . .	95H-200		for tools with 1" hex x 4-1/4" Nozzle . . . . .	95L-A340
	for Series 95 . . . . .	95H-200		Fronthead for tools with 7/8" hex x 3-1/4" Nozzle . . . . .	95L-240
22	Barrel Assembly . . . . .		70	for tools with 1" hex x 4-1/4" Nozzle . . . . .	95LA340
	for Series 93 . . . . .		71	Fronthead Pinch Bolt . . . . .	21-342
	with 7/8" hex Nozzle . . . . .	93H-AH100	*	Pinch Bolt Nut (ESNA # 29NE-083 Stop Nut) . . . . .	D02-904
	with 1" hex Nozzle . . . . .	93H-AH100-1	73	Retaining Lever . . . . .	95L-341
	with 3/4" Square Nozzle . . . . .	93H-AS100	74	Retaining Lever Plunger . . . . .	73L-245
	for Series 95 . . . . .		75	Retaining Lever Plunger Spring . . . . .	95L-246
	with 7/8" hex Nozzle . . . . .	95H-AH100	76	Retaining Lever Pin . . . . .	95L-342
	with 1" hex Nozzle . . . . .	95H-AH100-1			
* 23	Barrel Bushing . . . . .				
	for Series 93 . . . . .	73H-101			
	for Series 95 . . . . .	95H-101			
* 24	Nozzle . . . . .				
	7/8" hex . . . . .	73H-86			
	1" hex . . . . .	93H-186			
	3/4" Square . . . . .	73H-84			
• 25	Sleeve Locking Spring . . . . .	97MP-48A			
• 26	Retaining Sleeve . . . . .				
	Standard Type . . . . .	93H-22			
	Hitch Cutter Type . . . . .	273H-22			

\* Refer to OVERSIZE PARTS on page 3 before ordering.

\* Not illustrated.

• To keep downtime to a minimum, it is desirable to have on hand certain repair parts. We recommend that you stock one (pair or set) of each part indicated by a bullet (•) for every four tools in service.

† Complete assemblies are interchangeable with discontinued 93L-A140 and 93L-A240; however, component parts differ from those in the previous models and are not interchangeable. New Frontheads are stamped 95L-240 or 95L-340 for positive identification.

OVERSIZE PARTS

PART NUMBER FOR ORDERING

21	Oversize Piston .010" oversize for Series 93..... for Series 95.....	93H-200-10 95H-200-10
24	Oversize Nozzle 1" Hexagon .001" oversize..... .002" oversize.....	93H-186-10 93H-186-20

Piston (21): If the barrel bore becomes sufficiently worn to require an oversize Piston, the Barrel (22) must be returned to the factory for regrinding and installation of an oversize Barrel Bushing (23). A reground Barrel is stamped "10" or "20" above the nameplate to respectively indicate .010" or .020" oversize. Use only the corresponding oversize Piston in a stamped Barrel.

A Nozzle (24) whose outside diameter is .001" or .002" oversize can be furnished as a repair part. Do not increase the oversize each time the Nozzle is replaced, but only as the fit warrants it. Do not increase the oversize by more than .001" at any time. The amount of oversize is etched on the Nozzle for easy identification.

MUFFLER PARTS

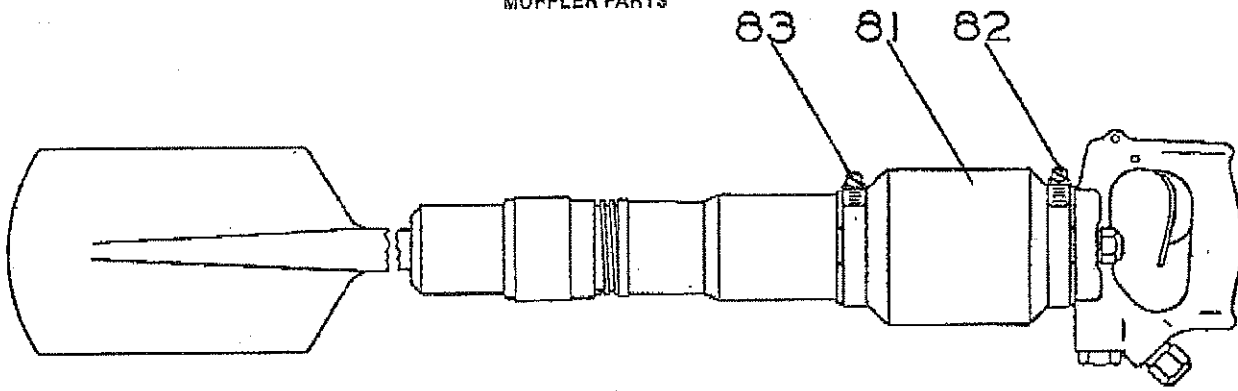

(Dwg. TPD431-1)

PART NUMBER FOR ORDERING

		Series 93	Series 95
81	Muffler Kit.....	93H-K674	95H-K674
82	Muffler (2).....	73H-674	75H-674
82	Large Clamp.....	59H-675	59H-675
83	Small Clamp.....	HHW1-676	HHW1-675

SWIVEL INLET PARTS

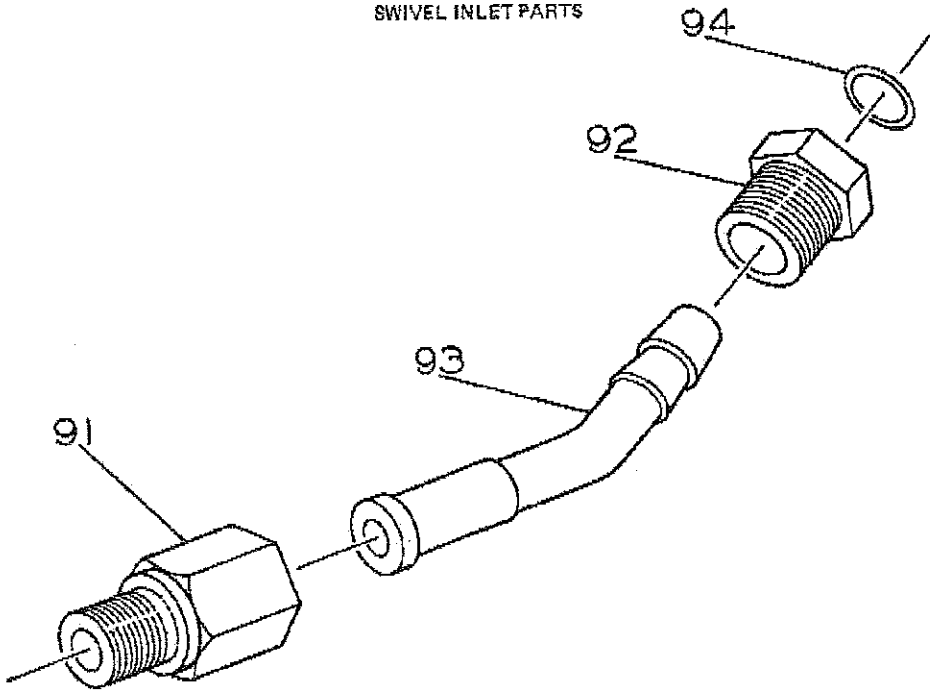

[Dwg. TFD821]

PART NUMBER FOR ORDERING

91	Swivel Inlet Assembly .....	HH1-A165
	Reducing Bushing .....	HH1-165
92	Swivel Inlet Sleeve .....	HH1-166
93	Swivel Inlet Nipple .....	HH1-167
94	O-ring .....	R00BR-210

MAINTENANCE TOOLS

TOOL NUMBER FOR ORDERING	TOOL NAME FOR ORDERING	OPERATION
MT2-27 57H-119	Socket Wrench .....	Removing or applying the Handle Bolt Nuts (16).
	Nozzle Ejecting Arbor .....	Removing the Nozzles (24) from the Barrel (22).