

CHIPPING HAMMER

CROWDER SUPPLY CO., INC. - 8495 ROSLYN ST. - COMMERCE CITY, CO 80022 - TOLL FREE 888-883-5144 - www.crowdersupply.com

INDEX NO.	PART NO.	DESCRIPTION	QUAN RECD.
1	6109	Throttle Pin	1
2	6110	Throttle Pin Sleeve	1
3	6111	Handle Bare (incl. 6110 & 6115)	1
	6111-C	Handle Complete	1
4	6113	Throttle Valve O-Ring	1
5	6114	Throttle Valve	1
6	6115	Throttle Bushing	1
7	6116	Throttle Spring	1
8	6117	Lever	1
9-A	6118-A	Lever Pin (Long)	1
9-B	6118-B	Lever Pin (Short)	1
10	6119	Throttle Plug	1
11	6122	Exhaust Cover	1
12	6123	Lock Ring	1
13	6136	Inlet Bushing	1
14	6144-R	Round Bushing	1
	6144-H	Hex. Bushing	1
15	6146	Valve Plate	1
16	6147	Ring Valve	1
17	6148-1	Cylinder for CH-1 Ring Valve	1
	6148-2	Cylinder for CH-2 Ring Valve	1
	6148-3	Cylinder for CH-3 Ring Valve	1
	6148-4	Cylinder for CH-4 Ring Valve	1
18	6102	Cylinder O-Ring	1
19	6103-1	Piston for CH-1	1
	6103-2	Piston for CH-2	1
	6103-3	Piston for CH-3	1
	6103-4	Piston for CH-4	1
30	9101	Retainer- Oval Collar	1
32	9105	Retainer Spring	1

OPTION

20	6101-1	Cylinder for CH-1 Shim, Flapper Valve	1
	6101-2	Cylinder for CH-2 Shim, Flapper Valve	1
	6101-3	Cylinder for CH-3 Shim, Flapper Valve	1
	6101-4	Cylinder for CH-4 Shim, Flapper Valve	1
21	6104	Shim Valve	1
22	6105	Top Valve Seat	1
23	6106	Bottom Valve Seat	1
24	6107	Valve Washer	1
25	6108	Valve Roller Pin	1
26	6161	Rear Valve Chest	1
27	6162	Flapper Valve	1
28	6163	Valve Cover	1
29	6164	Valve Roller Pin	1
31	9104	Retainer -Ball Bearing	1
33	9135	Inlet Swivel	1

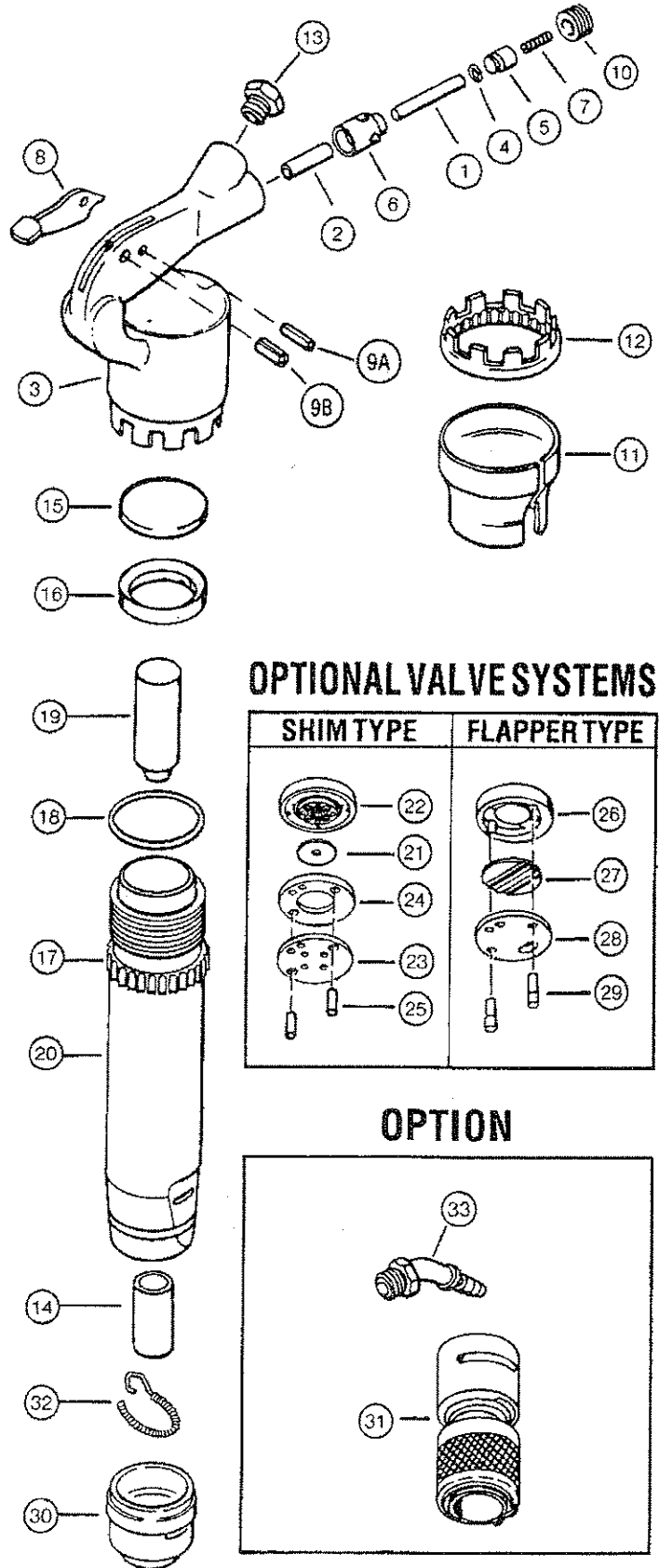

OPTIONAL VALVE SYSTEMS

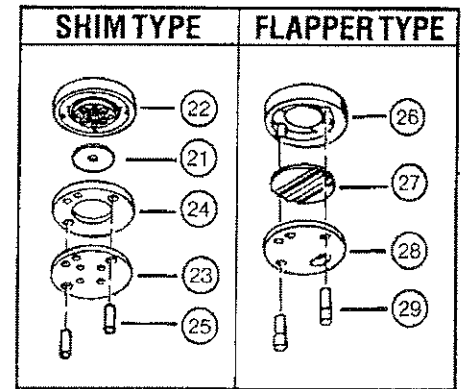

OPTION

